



Expeditions Five

Fat Facts



Expeditions Five is the second Teknicraft catamaran to run between Maui and Lanai.

SPECIFICATIONS

Length	55'
Beam	21.5'
Draft	5.5'
Passengers	108 + 3 crew
Engines	2 x Caterpillar C-18
Rating	715 hp @ 2100 rpm
Fuel Capacity	750 gal.
Propulsion	Osborne Props. (5 Blade)
Speed	24 kn. Cruise / 30 kn. Top
Construction	Aluminum - Marine Grade
Builder	All American Marine, Inc.
Designer	Teknicraft Design, Ltd.
Launched	November 2006
Classification	USCG Subchapter T

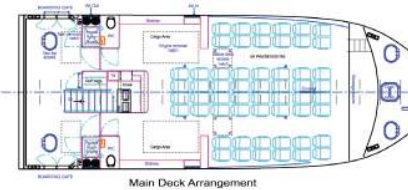
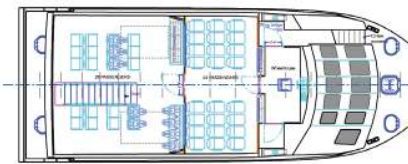
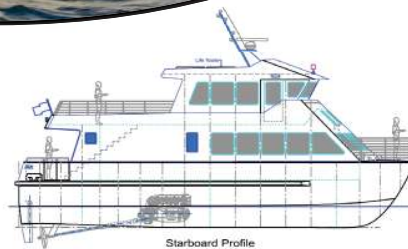

The Next Generation
in Catamaran Design

www.allamericanmarine.com

Expeditions Five is a certified USCG Subchapter T 55' x 21.5' Teknicraft catamaran designed to carry 108 passengers in Hawaii. The ferry shuttles passengers between Lahaina, located on the island of Maui and Manele Harbor on the island of Lanai.

The Expeditions Five is the successive vessel to Expeditions Four, which was previously ordered by the operator, Hone Heke Corporation and built by All American Marine in 2003. The early success of Expeditions Four and the fuel savings offered by the advanced hull design made it an easy decision

for Hone Heke to expand their fleet and order a second Teknicraft. The ferry will make new runs from Maalaea to Lanai possible in the near future.

The vessel features 2 air conditioned cabins, an exterior seating area, snack bar, and accommodates stowage of luggage and golf bags.

Expeditions Five is powered by a pair of Caterpillar C-18 diesel engines and offers passengers a fast and comfortable ride during the inter-island transit that operates five times daily.

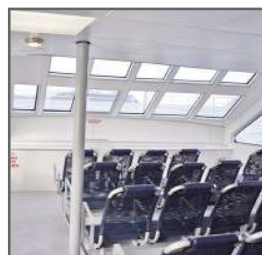

For more information contact:

All American Marine, Inc.

200 Harris Avenue

Bellingham, Washington 98225

Ph. 360.647.7602

Fx. 360.647.7607

Email: sales@allamericanmarine.com

Web: www.allamericanmarine.com